

The JBC logo is rendered in a bold, italicized, red sans-serif font. The letters are closely spaced, with the 'J' and 'B' being particularly prominent. The background of the entire image is a close-up, high-contrast photograph of a soldering iron. The iron's tip is on the left, with a bright blue heat-shrink tubing covering the handle. A plume of white smoke is rising from the soldering tip, which is in contact with a dark, metallic surface. In the background, a blurred control panel with several buttons is visible.

**JBC**

[www.jbctools.com](http://www.jbctools.com)

**Smart**  
Fume Extractor

# Why use a JBC smart Fume Extractor?

Avoid exposure  
to solder fumes

## Fume Extractor

Ref. **FAE2-5A** 100 V, 120 V, 230 V

The extractor **starts up when the tool is lifted from the stand**. This function saves power and the life of the equipment as well as the filters.



### Aspiration in use

The fume extractor starts working automatically **only when soldering**.



### Aspiration on the stand

The system detects **when the tool is returned to the stand** and the vent absorbs the fumes automatically.

Filter saturation indicator

You can control and monitor the equipment via JBC stations, a console or a PC.



Robust unit fitted with wheels and brakes so it can be easily moved around.

Aspiration tubes for up to 4 stands

Aspiration tubes for workbench 1



The **most efficient solution** thanks  
to the unique system **integrated**  
into the stand

## Intelligent control when connected to the Excellence range stations

Aspiration  
tubes for  
workbench 2

Aspiration  
tubes for up to  
4 stands

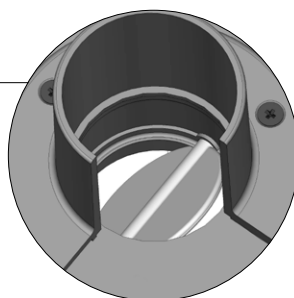

Air flow valve



Two handles facilitate filter change.  
You can also adjust the closing force  
with a nut.



Different possibilities of connection  
according to the working needs.

### 2 separate aspiration inlets

It can be used simultaneously  
in two work areas.

### 4 levels of aspiration

depending on requirements  
(low, medium, high & custom).

### Auto-control of the airflow

depending on the number of  
aspiration tubes in use and  
filter saturation.

### 4 working modes:

**1. Station:** The valve in the  
working area opens when the  
tool is lifted from the stand.  
Once the tool is returned to the  
stand and enters sleep mode,  
the valve in the work area  
closes and the stand valve  
opens. After a period of  
inactivity on both ports, the unit  
stops.

**2. Robot:** You can also  
manage the fume extractor  
using a robotic system by  
means of the RJ12 connector.

**3. Pedal:** You can activate the  
vacuum system with the pedal  
without being connected to a  
JBC station.

**4. Continuous mode:** the  
fume extractor works in  
continuous mode with the four  
valves opened.

## Connection with Excellence range

The station controls the vacuum tubes continuously for all the tools

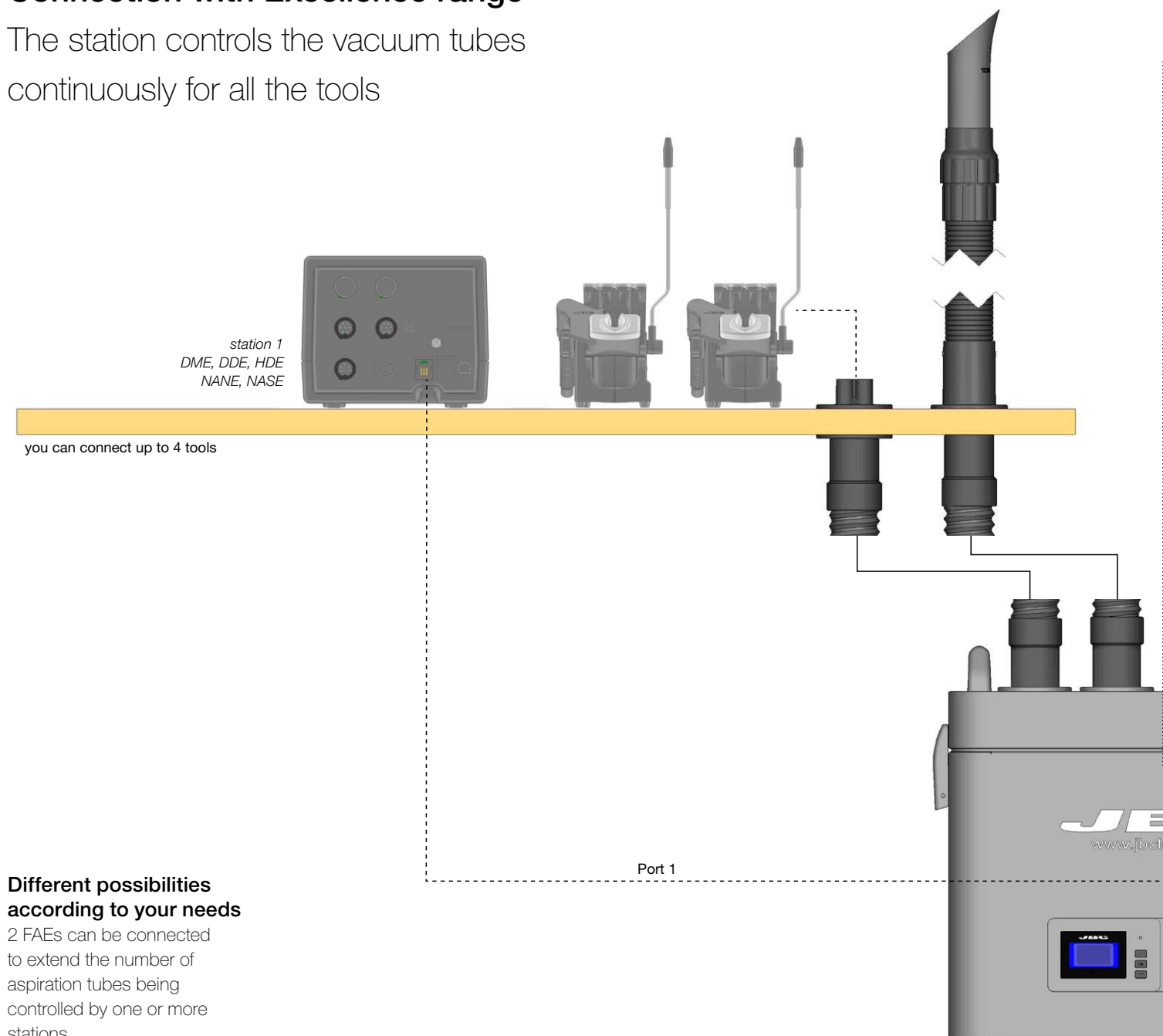

### Different possibilities according to your needs

2 FAEs can be connected to extend the number of aspiration tubes being controlled by one or more stations.

#### Option 1

Each station controls a port.  
Each stand inlet duct can be connected to up to 4 tools working independently.

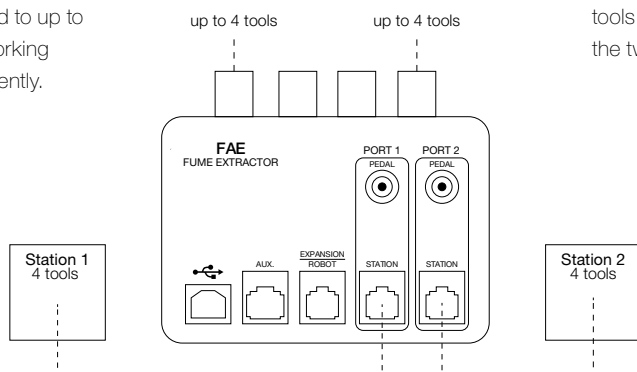

#### Option 2

The station controls both ports, being able to distribute the tools indistinctly between the two aspiration valves.

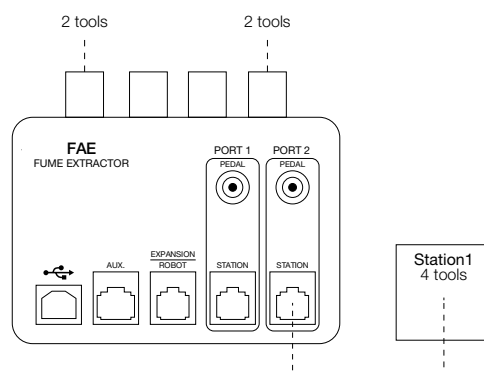

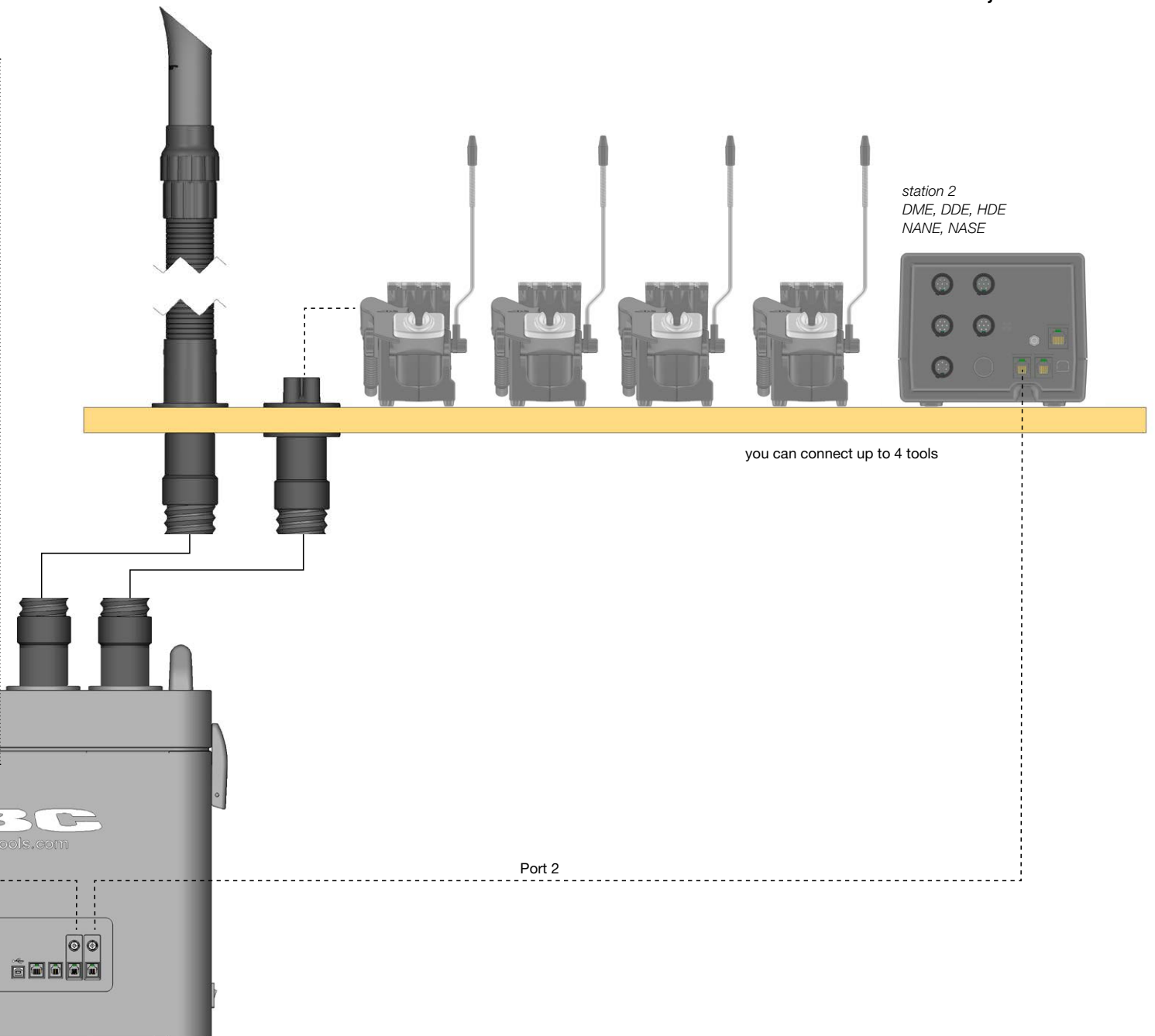

### Option 3

This option allows to daisy chain 2 fume extractors by means of the RJ12 connector. This means a station controls 2 equipments being able to distribute the tools among 4 work areas.

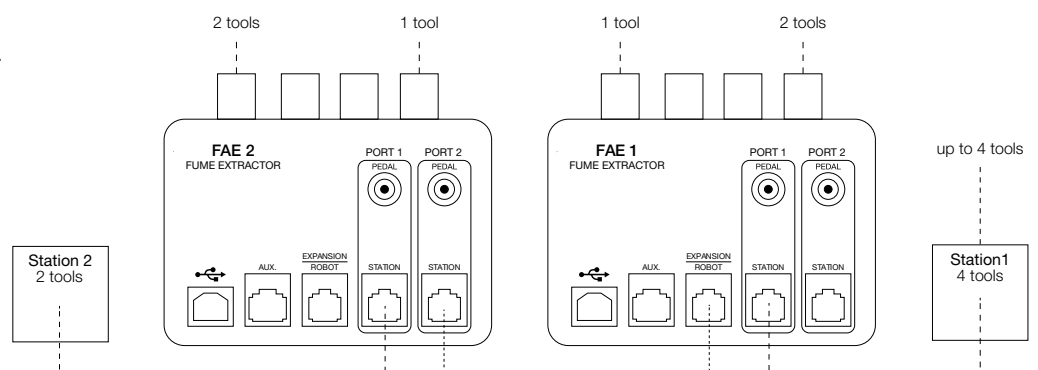



## Accessories

The station controls the vacuum tubes continuously for all the tools

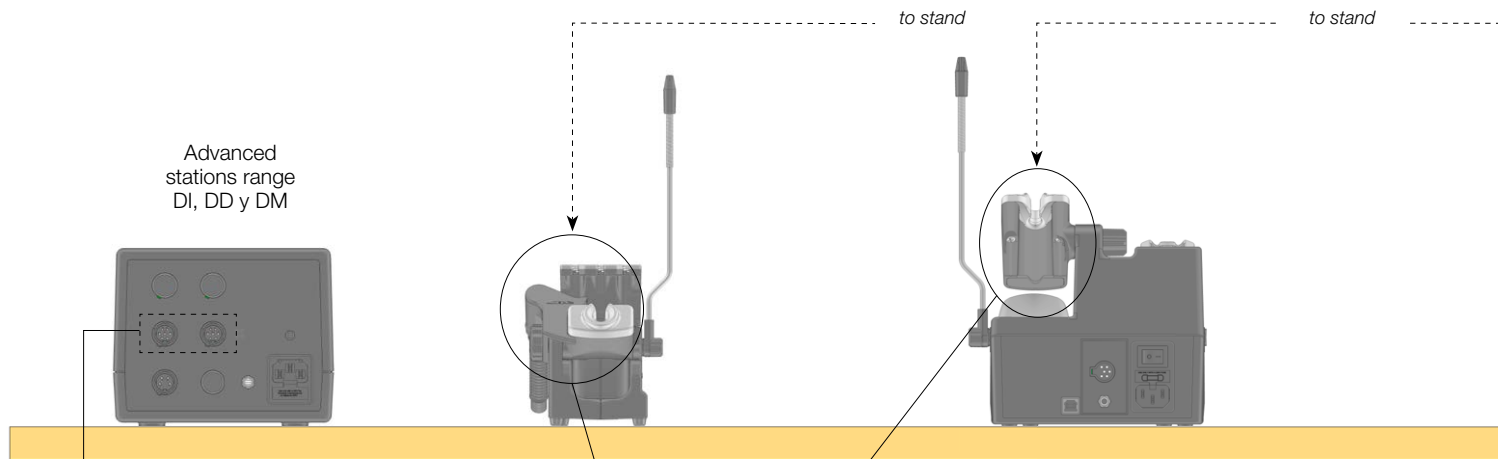

### Connection modules

To connect the FAE to the Advanced stations a connection module is required.

Ref. **FAE800**

For Compact stations.



Ref. **FAE900**

For DI, DD, DM control units.



### Fume Inlet Ducts for Stands

Ref. **FAE050**

Fume Inlet Duct for Modular Stands.

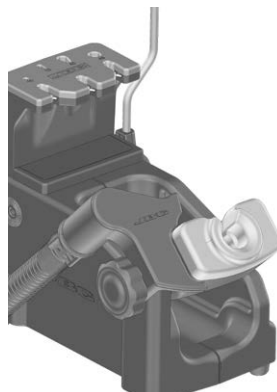

Ref. **FAE060**

Fume Inlet Duct for CD, CA, CP & CSV stations.



### Accessory for stand aspiration

Ref. **FAE030**

Accessory for stand aspiration. Connect up to 4 stands.

to stand's  
fume inlet  
ducts

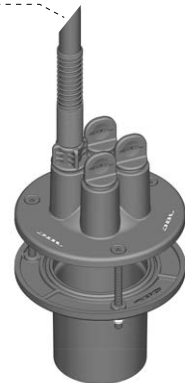

Ref. **FAE040**

Accessory for stand aspiration (up to 4 stands) + clamp to fix it in place.

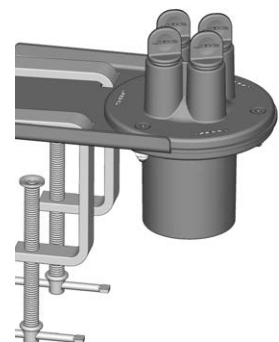

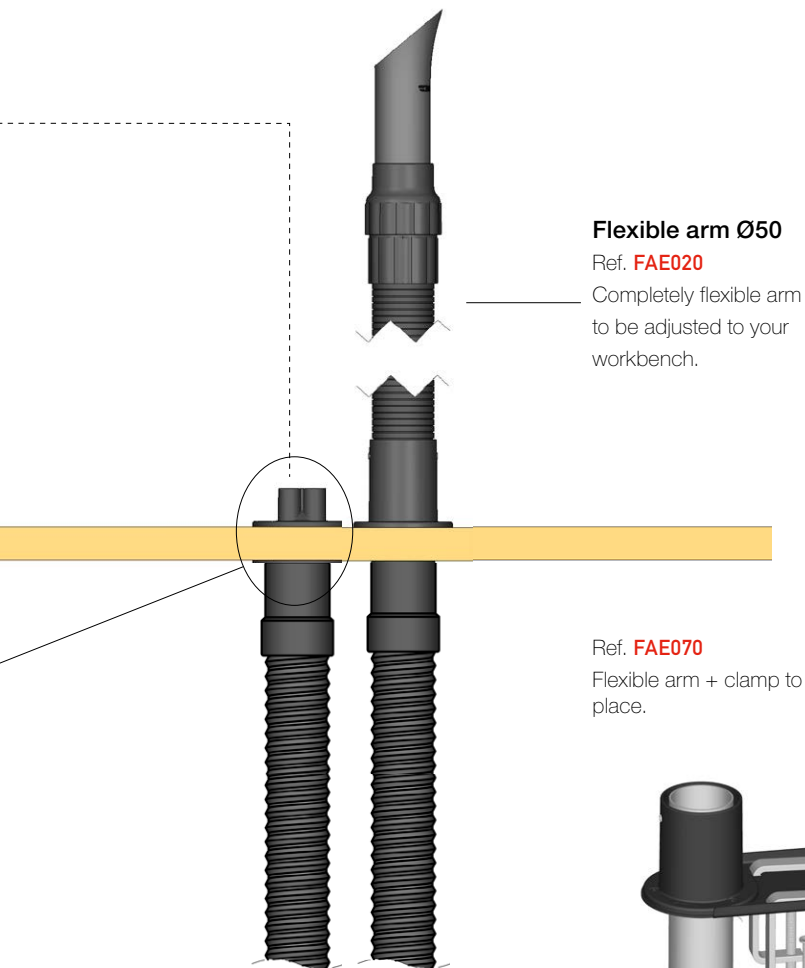

Ref. **FAE070**  
Flexible arm + clamp to fix it in place.

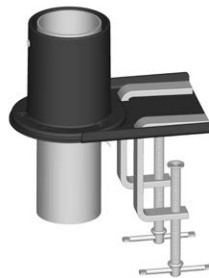

**Flexible Hose Ø50**

Ref. **FAE010**

Connect the Fume Extractor (FAE2-5A) to Flexible Arm.

**Fume Extractor**

Ref. **FAE2-5A**

## Filter saturation detection

The unit's sensors provide information about the level of saturation of the filters

### Compact three-layered filter

The combination of the three-layered filter system reaches a certified **filtering efficiency** of the soldering fumes up to 99.95% in accordance with norm EN 1822-4.

The unit has a LED warning to know when it's time to replace the pre-filter or the compact filter. In case the unit is connected to a station, the warning message will also appear on the station's display.

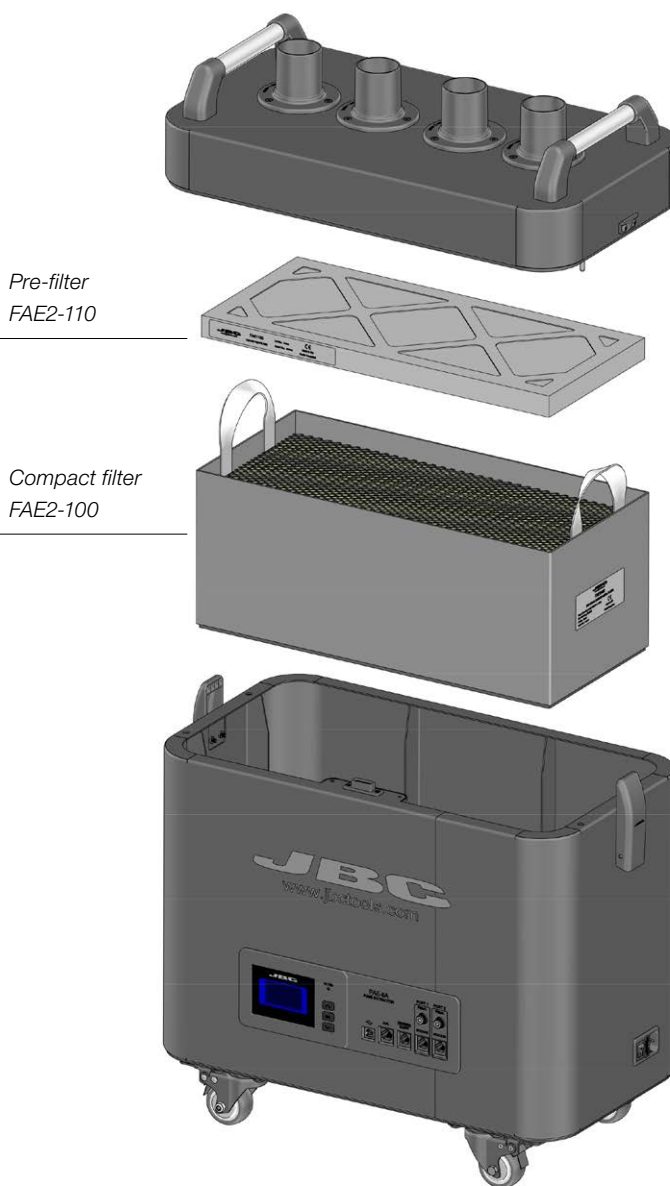

### Technical specifications

Long-life maintenance-free motor

Dimensions	558 x 292 x 562 mm (22 x 11.5 x 22.1 in)
Weight	25,5 Kg (56.2 lb)
<b>Ref.</b>	<b>FAE2-5A</b>
Voltage (AC)	100 V - 120 V - 230 V 50 / 60 Hz
Input Power	480 W (120 - 230 V) 330 W (100V)
Fuse	8 AT
Blower type	Brushless

Max. Flow rate	290 m <sup>3</sup> / h
Max. Vacuum	6,1 kPa
Filters	Prefiltro M5 (según la Norma EN 779)* HEPA H13 (según la Norma EN 1822)** Carbono
Work areas	2
Noise	54 dB

