



# 200 & 400

What to specify...

1. Model

2. Voltage

3. Volume or Vacuum

4. Pre-filter

5. Main filter

6. Connection Kit

7. Power Lead

8. Interfacing Kit

	1	2	3	200		400	
<b>Voltage</b>				<b>230V ±10%</b>	<b>120V ±10%</b>	<b>230V ±10%</b>	<b>120V ±10%</b>
<b>Volume Control</b>				<b>0LX2100D</b>	<b>0LX2101D</b>	<b>0LX4000D</b>	<b>0LX4001D</b>
<b>Vacuum Control</b>				<b>080026D</b>	<b>081026D</b>	<b>080410D</b>	<b>080411D</b>
<b>Wattage</b>				0.46 kW	0.47 kW	1.30 kW	1.37 kW
<b>Frequency</b>				50Hz / 60 Hz	50Hz / 60 Hz	50Hz / 60 Hz	50Hz / 60 Hz
<b>Cabinet height (inc castors)</b>				710 mm	710 mm	710 mm	710 mm
<b>Cabinet width (not inc hose)</b>				445 mm	445 mm	445 mm	445 mm
<b>Cabinet depth (not inc hose)</b>				528 mm	528 mm	528 mm	528 mm
<b>Cabinet weight</b>				50 Kg	50 Kg	50 Kg	50 Kg
<b>Sound Rating (dBA)</b>				52	55	52	55
<b>Airflow m³/hr</b>				150	150	467	456
<b>Vacuum (kPa)</b>				17.29	16.28	9.92	9.10

4

## Pre-filter Pad



Pack of four supplied - See page 19-20

5

## Main Filter



One supplied - See page 21-22 for your application

6

## Connection Hose Kit

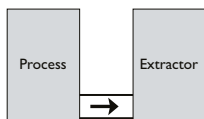

One supplied - See page 23-25 to suit your system

7

## Power Cable

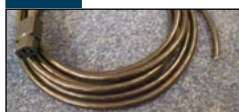

One supplied - See page 26 for your country & voltage

8

## Machine Interfacing (Optional)

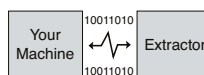

Allows the Purex system to interface with a piece of equipment connected to it.

See page 27-29 to match your system



Optional Clean Air Cowl - I90040

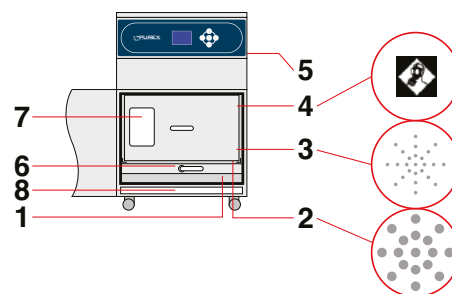

### Legend:

- 1) Air inlet - 80mm safe seal.
- 2) Pre-filter.
- 3) Main Filter (HEPA location). †
- 4) Main Filter (Carbon location). †
- 5) Clean air returned to workplace.
- 6) Filter locking handle.
- 7) Filter identification label.
- 8) Debris tray.

All machines are mounted on four castors for increased mobility.

† Standard Filter Only

## Digital Control System

A dedicated control, monitoring and display system unique to Purex fume extractors. All functions are fully automatic, all the user has to do is set the appropriate airflow on installation. The features of this system are designed to:

- Lower energy consumption by using variable speed motors and automatic flow control.
- Increase filter life by using the optimal extraction rate.
- Further protect people by constantly monitoring exhaust emissions.
- Interface with other equipment e.g. a laser.
- Maintain a constant extraction rate to prevent fume escape or damage to equipment.

## System Features...

- Automatic electronic flow control - maintains a constant extraction rate even as the filter blocks
- Adjustable airflow
- Clear and informative graphic display
- Gas and particle sensors on the exhaust
- Low capital and running costs
- Quick change pre-filters deliver longer filter life
- Submicronic (HEPA) filtration removes 99.997% of particles down to 0.3 microns
- Activated carbon filtration removes harmful gas
- Simple to install and quiet in operation
- Easy to relocate
- Precision made from stainless steel
- High performance brushless motors

## Includes:

- 1 x Main filter
- 4 x Pre-filter pads
- 1 x Connection kit
- 1 x Power cable

## Accessories

Please see the accessories brochure.