

Problem: Tablet camera C-mount connection

If after a long period of use the C-mount adapter gets disconnected from the camera of the tablet, it may happen that the adapter ring of the camera still sticks to the thread of the C-mount adapter [1].



[1]

This ring must be detached from the C-mount adapter [2] and put back to the connection point of the camera [3].

Often, the ring cannot be turned off the C-mount adapter with a bare hand. Pliers must be used in this case to help.

Caution: Use the pliers so that they do not damage the ring and its thread!



[2]



[3]

After the ring has been completely screwed back into the circular connection point of the camera, the two Allen screws (0.9 mm) must be tightened [4].

It is possible that these screws must first be loosened so that the ring fits into the thread.

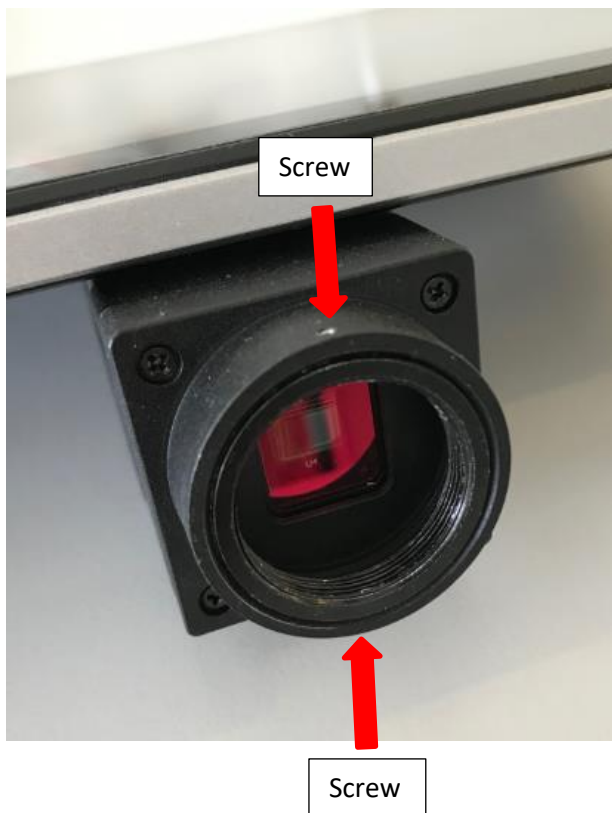

[4]