



www.jbctools.com

INSTRUCTION MANUAL



FAE060

Fume Inlet Duct for Compact Stations

This manual corresponds to the following reference:

FAE060

Packing List

The following items are included:



Fume Inlet Duct
for Compact Stations 1 unit
Ref. FAE060

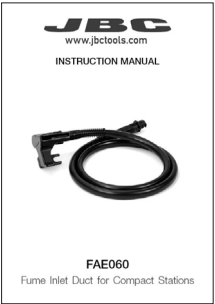

Manual 1 unit
Ref. 0029361

Connection



1 Turn the knob counterclockwise until it loosens.



2 Insert the fume inlet duct for compact stations between the knob and the tool holder.

Connection



3 Connect the fume inlet duct for compact stations to the accessory for stand aspiration (Ref. FAE030 or FAE040).

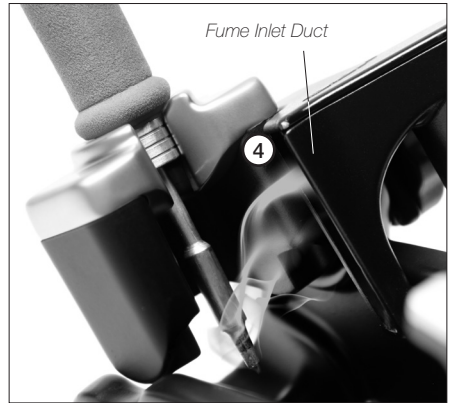

4 The system detects when the tool is returned to the station and the fume inlet duct automatically absorbs the fumes.

Maintenance

Before carrying out maintenance, always allow the tool to cool down.

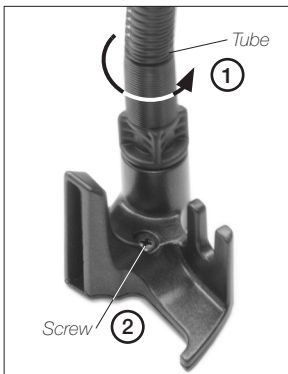

First Remove the hose by twisting it (1). Shake the hose to get rid of the dirt inside.

Then remove the screw (2).

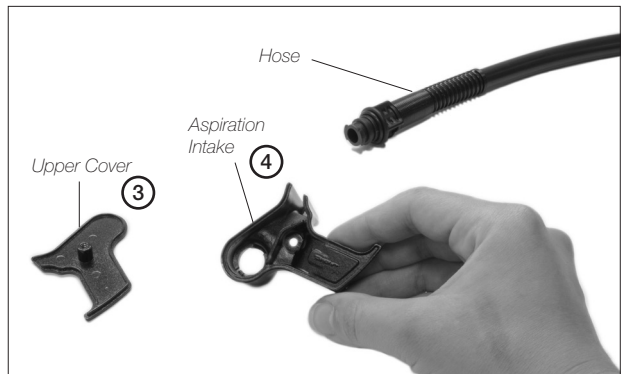

Dismantle the upper cover (3).

Clean the inside of the aspiration intake (4), if necessary with a cleaning stick.

Assemble all components in reverse order.

Specifications

FAE060

Fume Inlet Duct for Compact Stations

Ref.: **FAE060**

- | | |
|---|---|
| - Length: | 107 cm / 4.21 in |
| - Total Net Weight: | 186 g / 0.41 lb |
| - Total Package Dimensions / Weight:
(L x W x H) | 300 x 130 x 65 mm / 281 g
11.81 x 5.12 x 2.56 in / 0.62 lb |

Complies with CE standards.
ESD safe.

JBC

Warranty

JBC's 2 year warranty covers this equipment against all manufacturing defects, including the replacement of defective parts and labour.

Warranty does not cover product wear or misuse.

In order for the warranty to be valid, equipment must be returned, postage paid, to the dealer where it was purchased.



This product should not be thrown in the garbage.

In accordance with the European directive 2012/19/EU, electronic equipment at the end of its life must be collected and returned to an authorized recycling facility.

