

# **JBC**

[www.jbctools.com](http://www.jbctools.com)

## **INSTRUCTION MANUAL**



### **FAE020**

Flexible Arm ø50 mm

This manual corresponds to the following reference:

F AE020

Packing List

The following items are included:



**Flexible Arm ø50 cm** ..... 1 unit  
Ref. FAE020

**Screws** ..... 3 units  
DIN7982 - ø3.5x25 - black burnished  
Ref. 0019142



**Manual** ..... 1 unit  
Ref. 0019181

## Assembly Example

### FAE 020

Flexible Arm ø 50 mm

Take in mind the installation dimensions (see page 5 below)

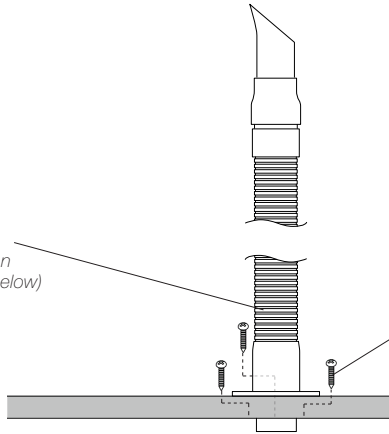

Fix the flange on your workbench with the supplied screws (more information at page 6)

### FAE010

Flexible Hose ø 50 mm

Total length: ~1.6 m / ~63 in

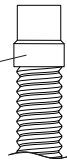

Connect the flexible Hose to the flexible Arm

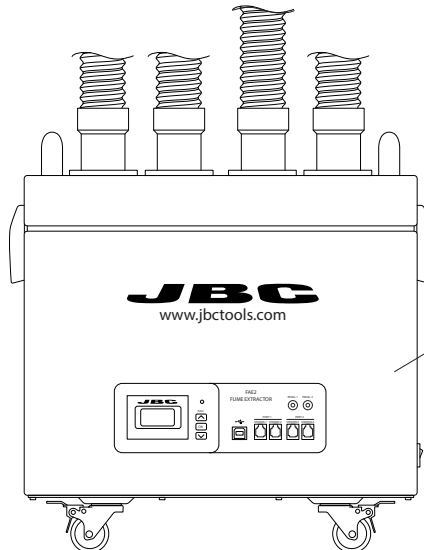

**FAE2**  
Fume Extractor

## Arm assembly

- When the flexible arm loses firmness, it must be re-compressed.
- For a greater compression, turn it slightly clockwise.
- Once the arm is compressed, adapt its position again.

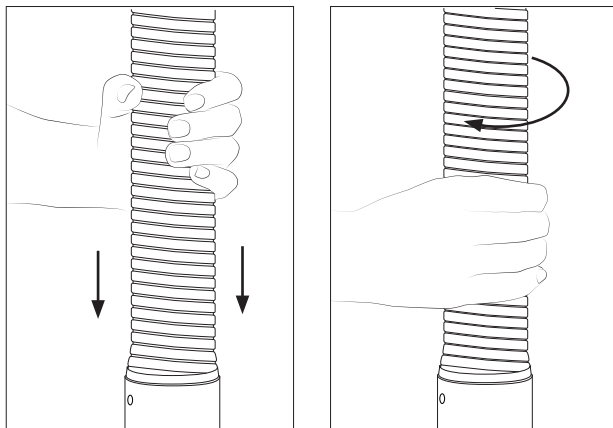

## Nozzles

You can replace the supplied nozzle and choose the one that best suits your needs.



**FAE080**  
Rectangular Nozzle for FAE  
aprox. 170 x 90 mm /  
6.69 x 3.54 in



**FAE081**  
Round Nozzle for FAE  
aprox.  $\varnothing$  120 mm /  
 $\varnothing$  4.72 in



**FAE082**  
Large Rectangular Nozzle for FAE  
aprox. 227 x 107 mm /  
8.94 x 4.21 in

## Nozzle Replacement

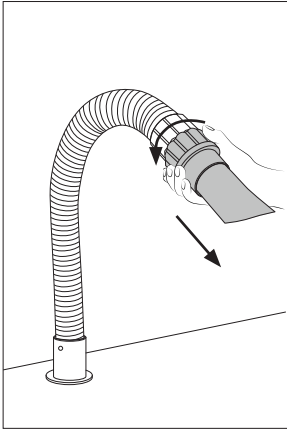

The bayonet system makes it easy to change the nozzle. To do this, hold the tube with one hand and with the other turn the nozzle counter-clockwise and pull it out to remove the nozzle.

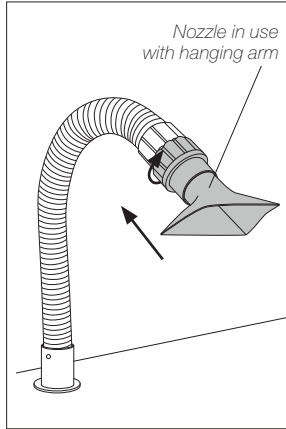

To install a new nozzle, turn the nozzle bayonet clockwise to lock it in place.

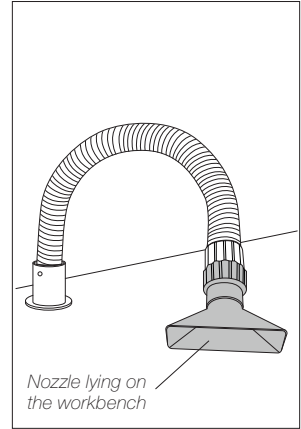

The nozzles are designed in such a way that they can be used with a hanging arm or be lying on the workbench.

## Installation Guide Line

To protect flexible arm tube from braking follows this installation guide line.

**Note:** In case of a breakage, the windings can be plugged back into each other. To do this, align the windings with one another and push them back together with strength.

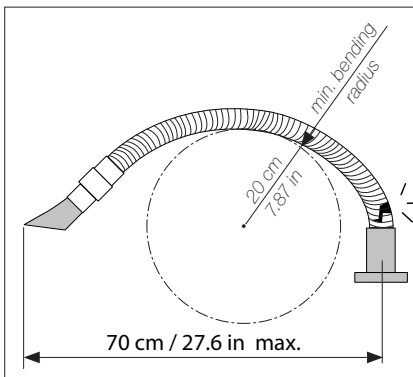

To avoid breaking the arm, do not extend the arm more than 70 cm / 27.6 inches from the center of its base and do not go below the minimum bend radius of 20 cm / 7.87 inches.

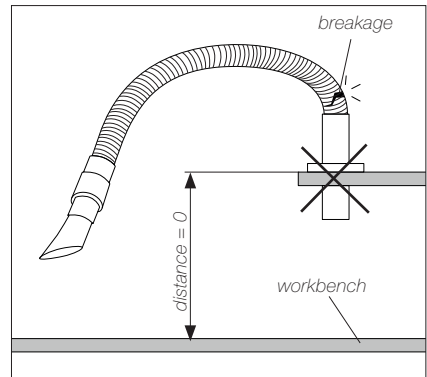

Do not install the flexible arm on shelves or higher levels than the work bench. Forced bending radii can cause the arm to break.

## Dimensions Scheme for FAE020 Fixing

To assemble the flexible arm FAE020 (Ø50) for the first time follow these instructions:

- First make the large central hole in your workbench as shown in the drawing below.
- Place the FAE020 flange in the opening and mark the points for the three pilot holes.
- Take out the flange and drill the three holes at the marked spots. The hole diameter can be found in the dimension scheme:

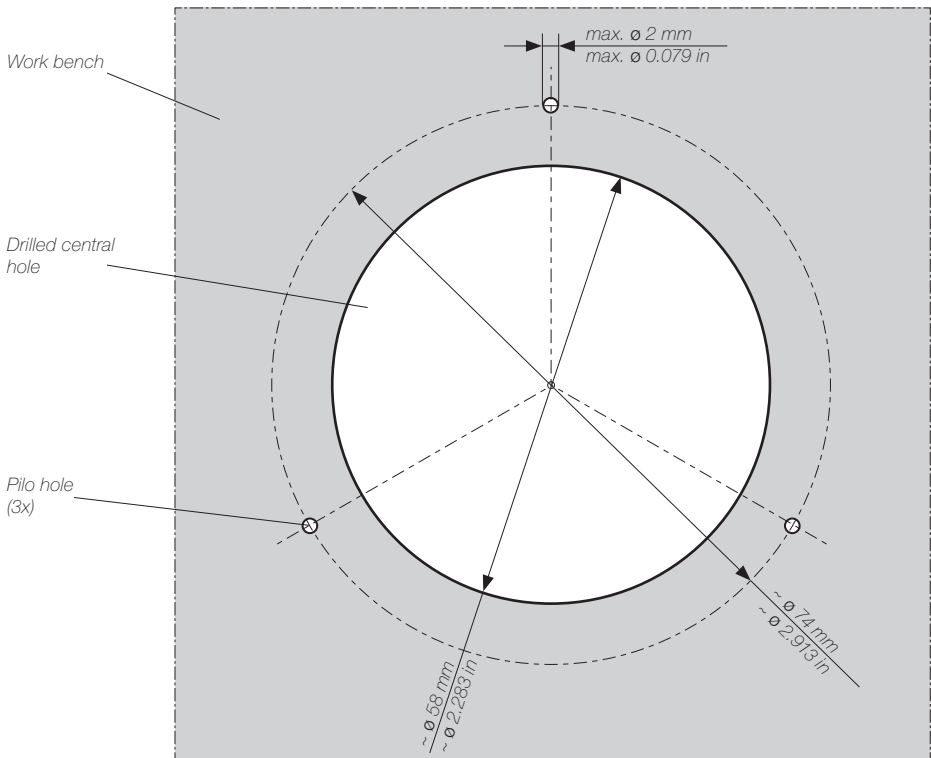

## Notes

This image shows a single sheet of white paper with horizontal blue or grey ruling lines. The lines are evenly spaced and run across the width of the page. There are no margins, text, or other markings on the paper.

## Specifications

### **FAE020**

**Flexible Arm ø50 mm**

Ref. **FAE020**

- |   |  |
|---|--|
| - Inner Tube Diameter:                        | ø50 mm / ø1.97 in  |
| - Total Net Weight:                           | 1,76 kg / 3.88 lb  |
| - Package Dimensions / Weight:<br>(L x W x H) | 1050 x 170 x 120 mm / 2.5 kg<br>41.34 x 6.69 x 4.72 in / 5.51 lb |

Complies with CE standards.  
ESD safe.

# JBC

### **Warranty**

JBC's 2 year warranty covers this equipment against all manufacturing defects, including the replacement of defective parts and labour.

Warranty does not cover product wear or misuse.

In order for the warranty to be valid, equipment must be returned, postage paid, to the dealer where it was purchased.



This product should not be thrown in the garbage.

In accordance with the European directive 2012/19/EU, electronic equipment at the end of its life must be collected and returned to an authorized recycling facility.



[www.jbctools.com](http://www.jbctools.com)