

JBC

www.jbctools.com

English



Premium Complete Rework station with Electric Pump

Ref. RMSE-C

Index

Packing list3

JT Hot Air station

Features 7
Stand & Nozzle changer 8
Protectors & Extractors10
T260 Pick & Place11
Operation & Process Control with JT12
JT-TA Replacing the Heating Element15
JT-TA Changing the Heater Hose Set 15

DDE Control Unit & MSE Module

Features 16
Stands & Tip Cleaner 18
T245 Changing Cartridges20
DR560 Changing Tips21
DR560 Changing the Heating Element ...22
DR560 Tin Deposit Cleaning23
DR560 Tip Care24
Desoldering Process DDE & MSE24
MSE Initial Setup25
MSE Changing the pump filters25
Operation with DDE 26
Process Analysis28
Soldering Net29
Working with robots30
Station Software30

Maintenance 31

Safety32

Specifications 33

Exploded View 34

Packing List

The following items should be included:

JTE Control Unit1 unit

Ref. JTE-1D (120V)
JTE-2D (230V)
JTE-9D (100V)

DDE Control Unit1 unit

Ref. DDE-1B (120V)
DDE-2B (230V)
DDE-9B (100V)

Electric Desoldering Module.....1 unit
Ref. MSE-A



Stand1 unit

Ref. JT-SD

Stand1 unit

Ref. AD-SD

Stand1 unit

Ref. DR-SD



Heater hose set1 unit

Ref. JT-T1A (100V / 120V)
JT-T2A (230V)

Soft Thermal Insulator

Handle1 unit
Ref. T245-C

Desoldering Iron..... 1 unit

Ref. DR560-A



JT Accessory set
Ref. 0012332

Extractor stand*1 unit
Ref. 0008752

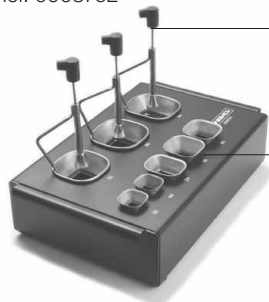

Extractors*
Ref. E2184
E2064
E2052

Tripod*
Ref. T2050 (Ø 39mm)
T2250 (Ø 85mm)



Protectors*
Ref. P2220
P2230
P2235
P4000
P4010

Suction Tube*
Ref. 0932330



Tip Cleaner.....1 unit
Ref. CL9885



Suction Cups*
Ref. 0930110
Ø 10 - 0934050 (x3)
Ø 4.7 - 0934070 (x1)



Nozzles
Ref. JN2015 (x1)
JN2012 (x1)
JN2020 (x1)



Cartridges.....2 units
Ref. C245903
C245906



Sponge1 unit
Ref. S0354



Metal Brush1 unit
Ref. CL6217



DR560 Accessories
Ref. 0010211

Tip cleaning set1 unit
Ref. 0965970



Long Tip Cleaning set1 unit
Ref. 0965760

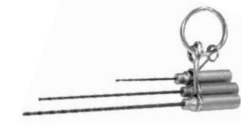

Tips3 units
Ref. C560005
C560013
C560004



Tin deposit1 unit
Ref. 0812620



Spanner1 unit
Ref. 0780550



Filter Box1 unit
Ref. 0780840
*It contains
10 filters*



Internal joint Case.....2 units
Ref. 0812360



Metal tin deposit1 unit
Ref. 0812630



Cartridges.....2 units
Ref. C245903
C245906

Sponge1 unit
Ref. S0354

Metal Brush1 unit
Ref. CL6217

Cotton Filter1 unit
Ref. 0781046
It contains 10 filters



Filter Box1 unit
Ref. 0005966
It contains 50 filters



Suction Filter1 unit
Ref. 0821830



* These accessories are not supplied with JT-2QC / JT-1QC / JT-9QC stations.

JT Features

Pick & Place.....1 unit
Ref. T260-A



Bent Needles Set.....1 unit
Ref. 0861660



Straight Needles Set.....1 unit
Ref. 0901546



Cups Set.....1 unit
Ref. 0940163



Cleaning stick 1 unit
Ref. 0786640



Stand Cable.....2 units
Ref. 0011283



Module Cable1 unit
Ref. 0014874



Union Flanges1 unit
Ref. 0011356



Power cords

For DDE 1 unit
Ref. 0013671 (100/120V)
0010569 (230V)



For JTE.....1unit
Ref. 0009417 (100V/120V)
0009401 (230V)



Manual1 unit
Ref. 0016197

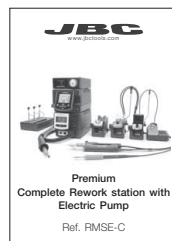

USB-B connector

Update the station software from the JBC website

Activates the suction pump



Suction Tube

Ref. 0932330
For tripods and extractors



Another connectable tool:

Precision Heater hose set

Ref: TE-TB

Heater Hose set

Ref. JT-T1A (100V/120V)
JT-T2A (230V)

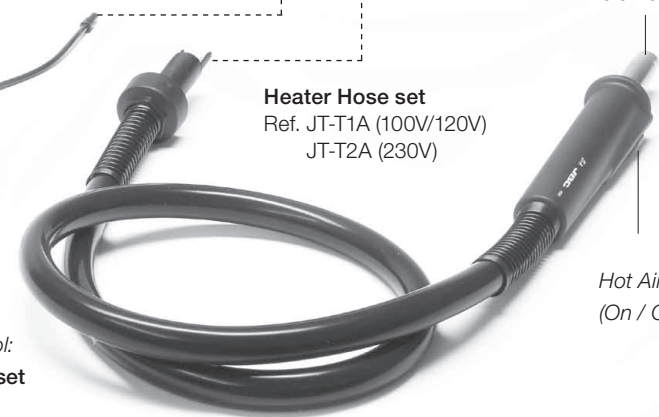

Stand

Ref. JT-SD

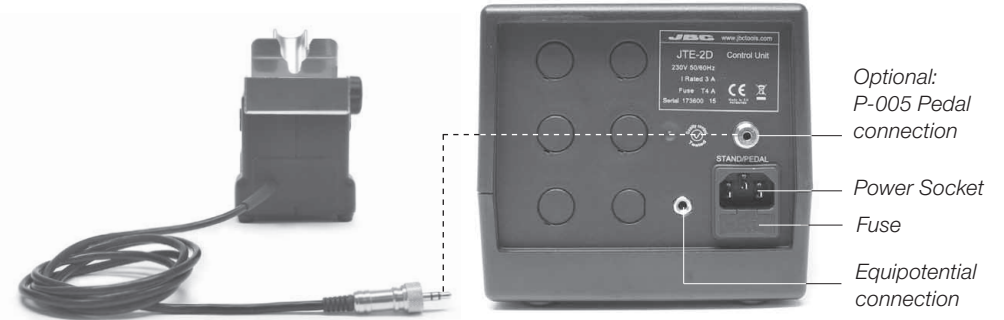

Adjustable Stand

Adjust the tool holder angle to suit your work position.

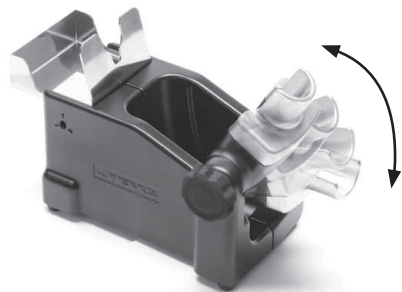

Operation Modes

1. From the main Menu, select the mode to activate the tool depending on the task.

Stand + Autostart OFF



Press the start/stop button to blow hot air.

Stand + Autostart ON



The tool automatically starts blowing hot air when lifted from the stand.

Pedal*

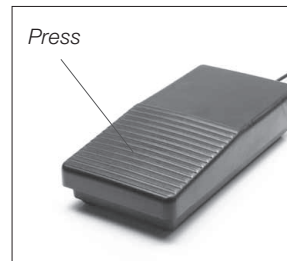

Press the Pedal to blow hot air and release to stop.
*The **P-005** Pedal is not supplied with this station. See our website.

2. The tool stops blowing hot air when returned to the stand.

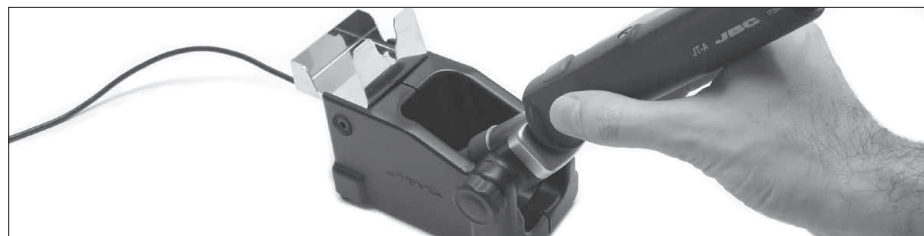

Quick Nozzle Changer

Changing nozzles quickly and safely.

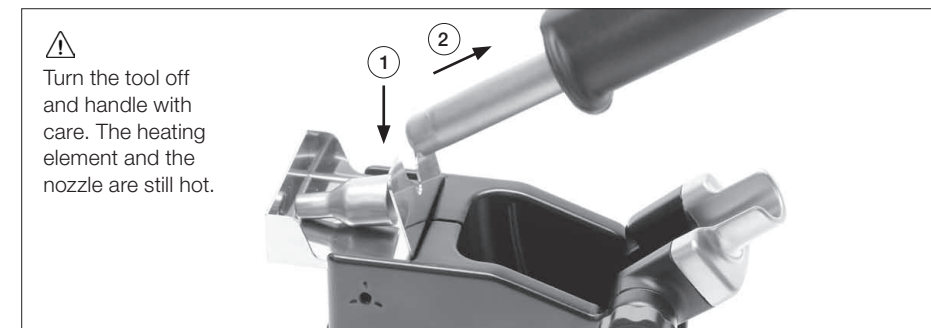

Compatible Nozzles

The JT-TA works with JT nozzles. Find the model that best suits your soldering needs in www.jbctools.com

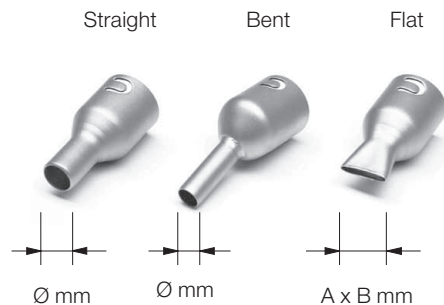

Ref.	Shape	Size
JN2020	Straight	Ø 8mm
JN8417	Straight	Ø 10mm
JN2015	Bent	Ø 4mm
JN2012	Bent	Ø 6mm
JN6633	Bent	Ø 8mm
JN7637	Flat	10 x 2mm
JN7638	Flat	20 x 2mm
JN7639	Flat	30 x 2mm

In case of a loosely fitting nozzle:

1. Push the nozzle tab inwards with a screwdriver or flat-nosed pliers.



2. Insert the nozzle into the JT-TA Heater again.

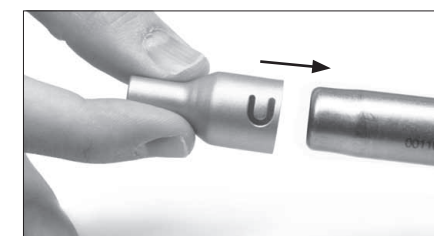

Protectors & Extractors

For small components (fig. 1 and 2).

We recommend using the protector + tripod

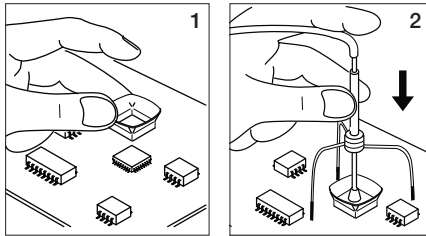

For large components (fig. 3 and 4).

We recommend using the extractors

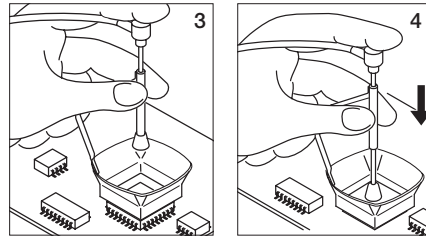

Protectors

* Ref.	AxB (mm)	* Ref.	AxB (mm)
P3353	4,3 x 3	48 P2230	15 x 15
P3786	5,2 x 5,2	60 P4010	17 x 17
P3352	5,2 x 7,5	P4005	18 x 29
P3355	5,2 x 9,5	P4030	18,5 x 18,5
P3356	6,2 x 4,2	P1068	18,5 x 24
P3785	7,2 x 7,2	P2685	28,5 x 28,5
P3784	8,2 x 8,2	P4085	31,5 x 31,5
P4035	9 x 13	P2672	33 x 46
P4040	9,5 x 19	P4002	50 x 50
P4080	9,5 x 21	P3357	52,5 x 14
32 P2220	10 x 10		
P4045	10,5 x 21		
P4090	11 x 16		
24 P2235	12 x 17		
P1249	12 x 23		
44 P4000	12,5 x 12,5		
P3354	13,2 x 13,2		
P4025	13,5 x 21,5		

* Reference Desk

Extractors

* Ref.	AxB (mm)	* Ref.	AxB (mm)
52 E2052	20 X 20	E2124	45 X 45
64 E2064	20 X 26		
80 E2184	24 X 24		
E2068	27 X 27		
E4020	28,5 X 28,5		
E4015	31,5 X 31,5		
E2084	33 X 33		
E2100	38 X 38		

Tripods

* Ref.	øC (mm)
T2050	39
T2250	85

Manual extractor

* Ref.	øD (mm)
E2190	7

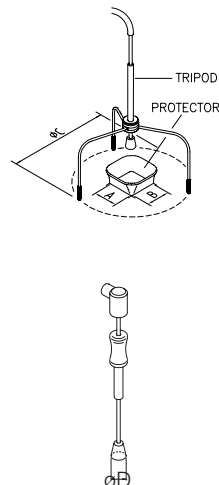

T260 Pick & Place

This tool helps place and remove SMDs of any size thanks to the suction provided by the station.

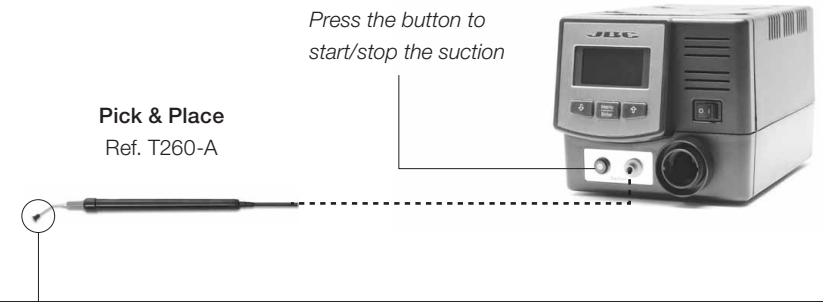

Pick & Place
Ref. T260-A

Press the button to start/stop the suction

Choose the **suction cup** that best fits the component (Maximum working temp.: 250°C / 482°F):

Insert the needle with the appropriate cup for a correct suction process.

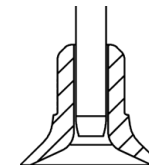

You should avoid the needle to stick out of the lower part.

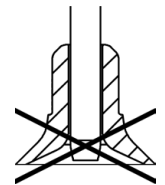

Operation

1. Suction

Once activated the suction button, cover the pen hole with your finger and pick the component.



2. Release

Lift your finger to release the component on the appropriate place.

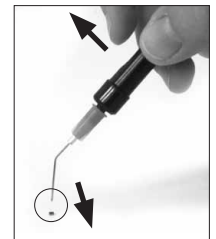

Operation with JT station

1. Placing

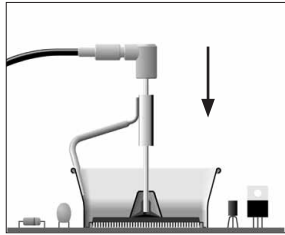

Position the extractor with the appropriate suction cup and press the suction button.

2. Heating

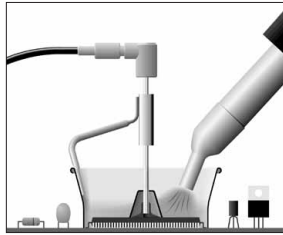

Heat the component.

3. Releasing

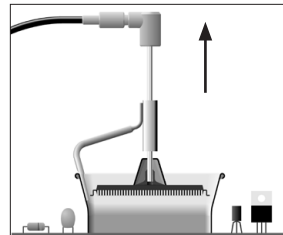

The component lifts off automatically when the solder melts.

Process Control

Manual Mode

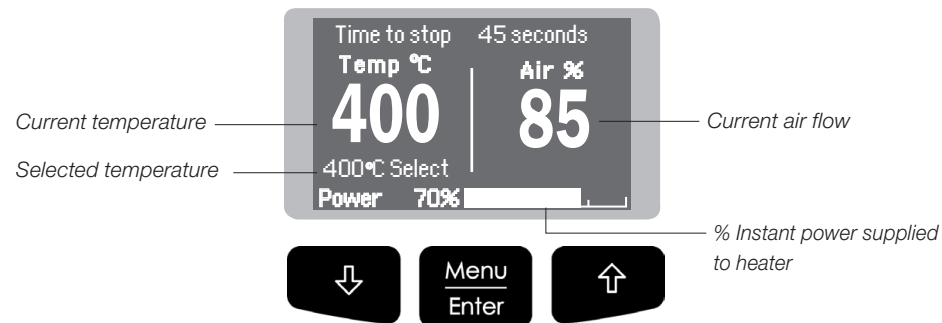

Access Menu (press key 2 seconds) & Confirm Selection

You can switch between operating modes (Manual Mode / Program Mode) by pressing the "increase" and "decrease" keys simultaneously for 2 seconds (Only when programs mode is ON).

Program Mode

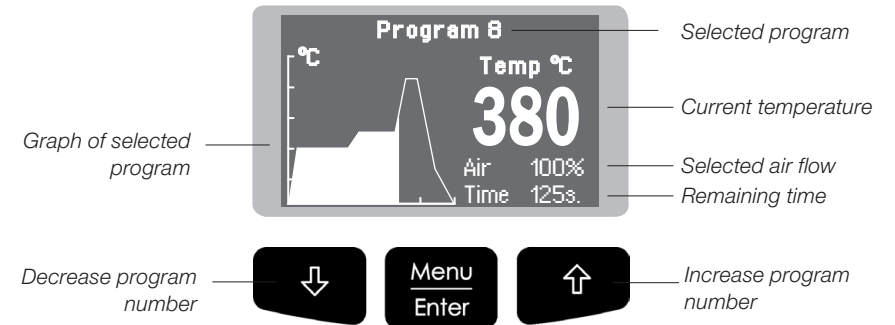

Program Options

Edit Program

This option allows you to edit or create a program.

First, you must select the program to edit and then modify the points that make up the program.

Each program is composed of 9 points, each point consisting of 3 parameters:

1. Time (seconds)
2. Temperature (°C / °F)
3. Flow rate (%)

You can delete the last point of the program by selecting "-----" in the time parameter.

It should be taken into account that the regulation range permitted by the station is 150-450°C, whereby it is not possible to create temperature ramps between room temperature (Toff) and 150°C.

The station can store up to 25 temperature programs.

The first three programs are edited by JBC as an example.

Copy Program

This option allows you to copy a program.

You must select the program source and its destination (where it will be copied).

Delete Program

This option will allow you to delete a previously selected program.

Menu Screen

Original PIN: 0105

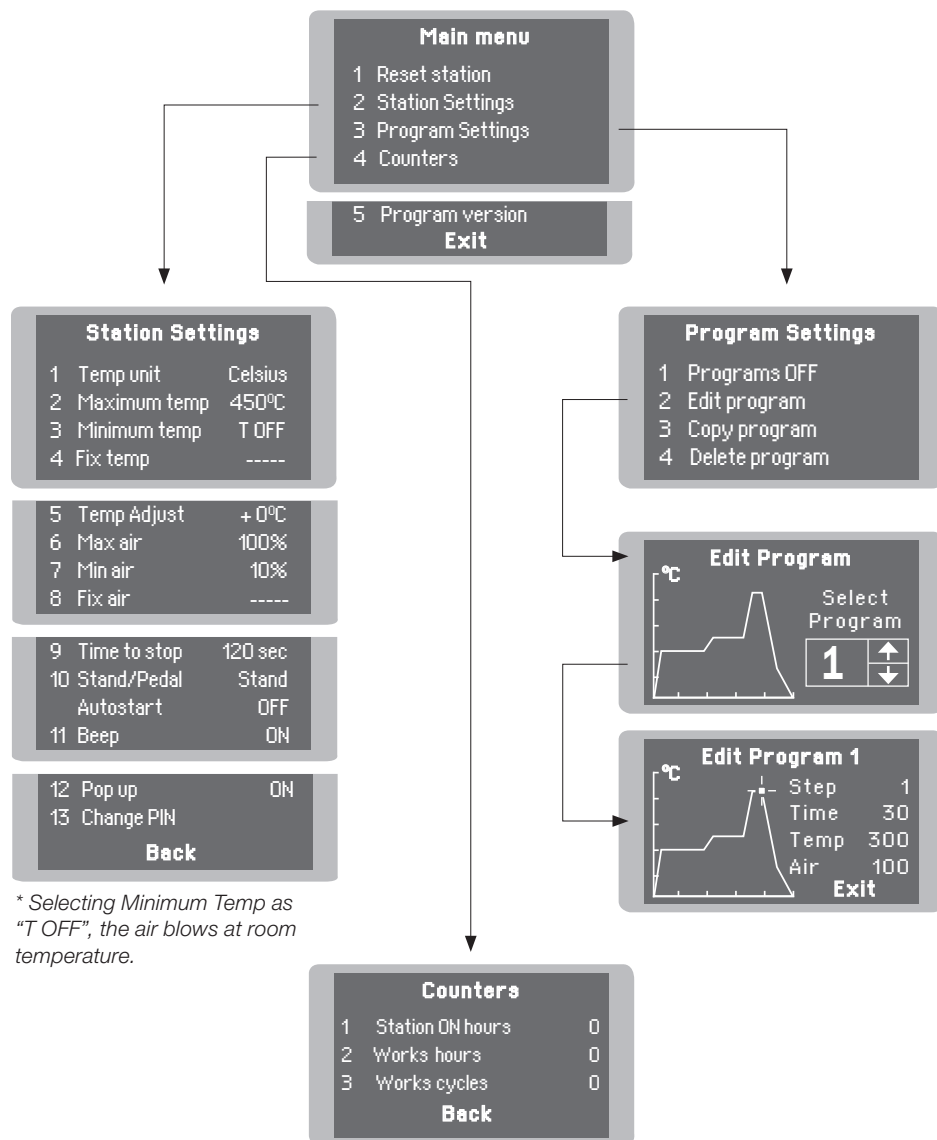

JT-TA Replacing the Heating Element

Only perform this operation when the element is cold and the unit is disconnected from the mains.

1. Loosen the screw.
2. Pull the heating element away from the handle.
3. Connect the new heating element, ensuring its pushed all the way in.
4. Tighten the screw.

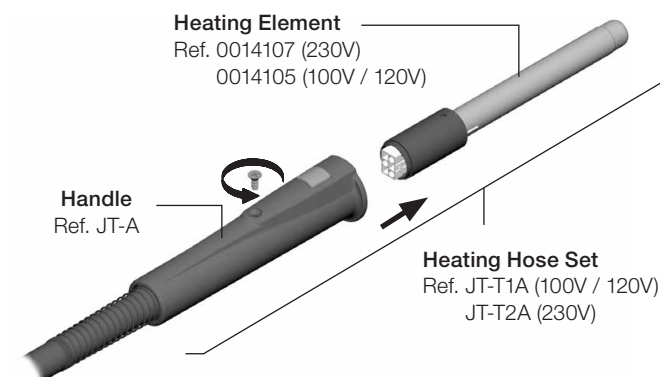

JT-TA Changing the Heater Hose Set

1. Ensure that the tool is turned off.
2. Use a spanner to unscrew the connecting nut.
3. The tube end of the new heater must be inserted so that the longitudinal rib fits into the groove.
5. Follow the same steps conversely.



DDE & MSE Features

Work simultaneously with **up to 2 tools** and join each station port with **1 module + 1 pedal** (Peripherals).

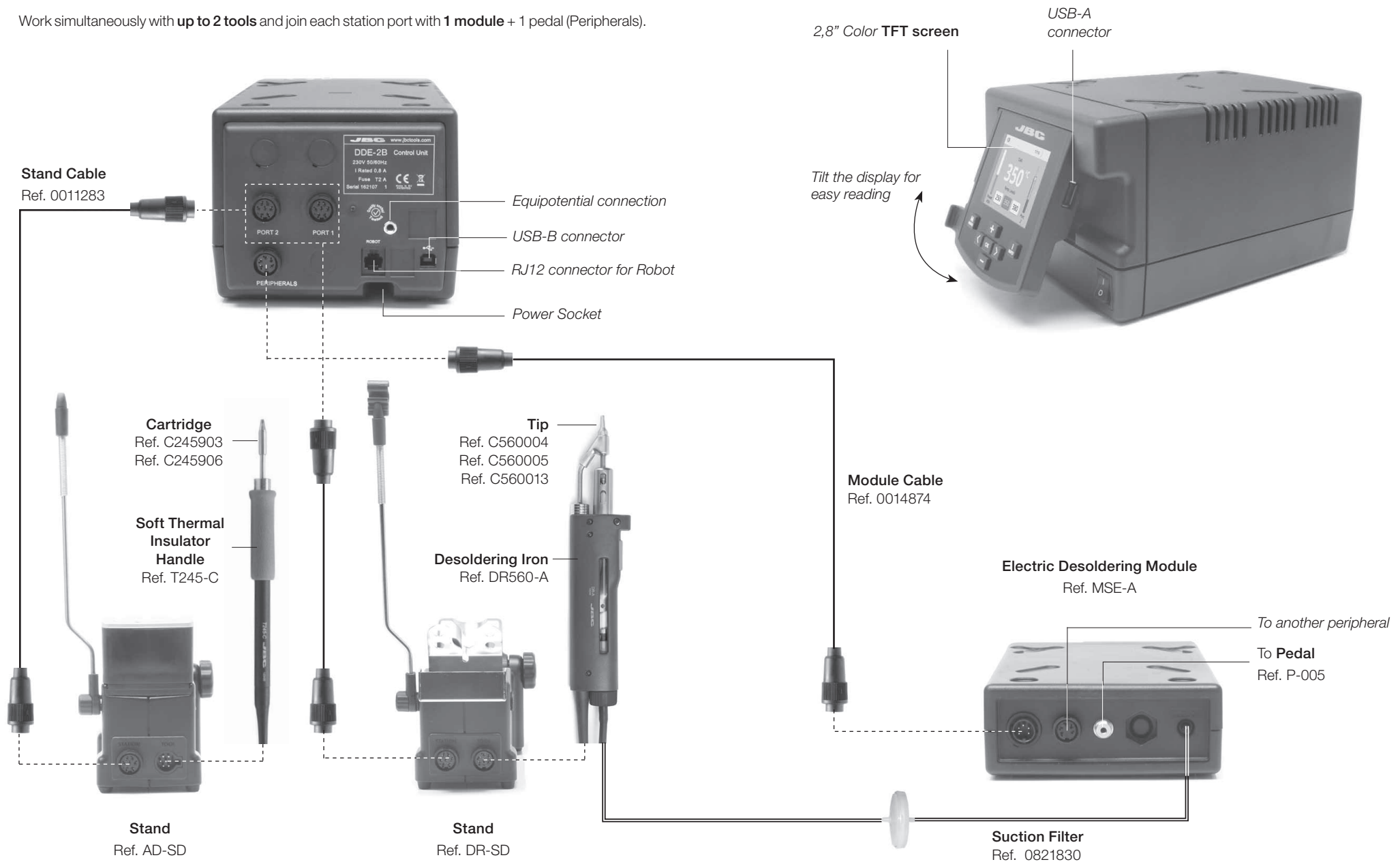

Adjustable Stands

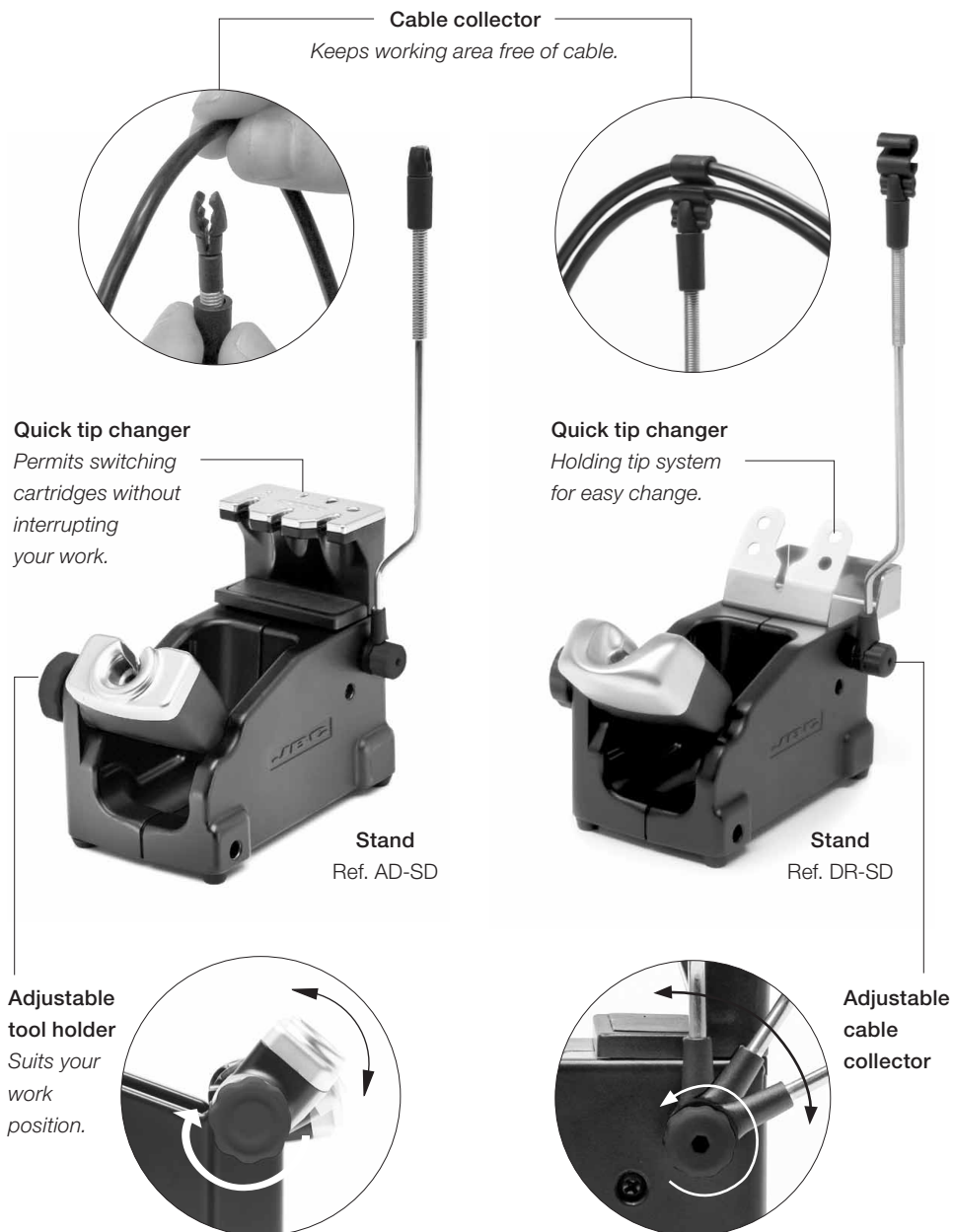

Tip Cleaner

Improve thermal transfer by cleaning the tip after each solder joint.

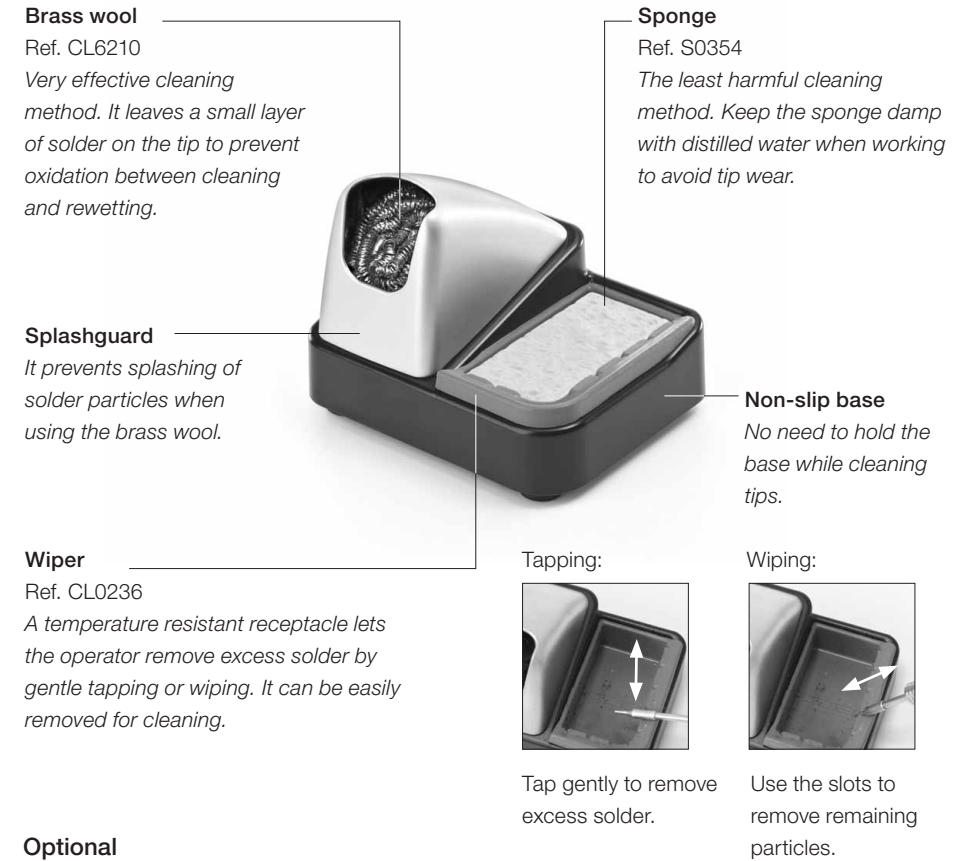

Optional

Inox wool
Ref. CL6205



Brushes
Ref. CL6220



Tip-tinner
Ref. TT-A



Sand
Ref. CL6211



T245 Changing Cartridges

Save time and change cartridges safely without switching the station off.

1. Removing

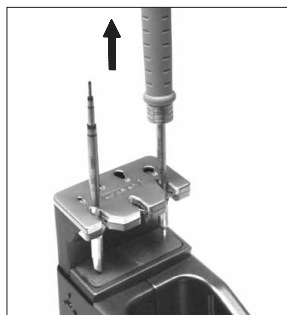

Place the handle in the extractor and pull to remove the cartridge.

2. Inserting

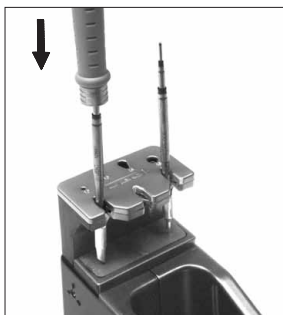

Place the handle on top of the new cartridge and press down slightly.

3. Fixing

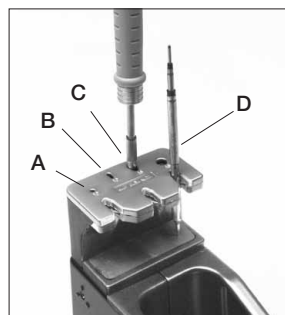

Use the holes for fixing the cartridge* as follows:
A. For straight C210.
B. For curved C210.
C. For curved C245.
D. For straight C245.

*Important

It is essential to insert the cartridges as far as the mark for a proper connection.



Compatible cartridges

The T245 handle works with C245 cartridges. Find the model that best suits your soldering needs in www.jbctools.com

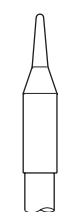

Round



Chisel



Round bent

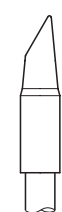

Bevel

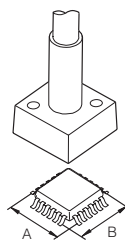

Special models

DR560 Changing Tips

This operation should be done while the tip is hot, not below 250°C, so that any tin left inside is in molten state.

1. Removing

Unscrew the tip using the spanner supplied.

2. Inserting

Fit the new tip and tighten with the spanner to make sure it is air tight.



Compatible Tips

The DR560 works with C560 tips. Find the model that best suits your soldering needs in www.jbctools.com
 Here are some C560 tips in real size (in mm):

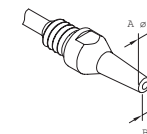

C560-001 ØA=1,4 ØB=0,6 Ømax. pin=0,4

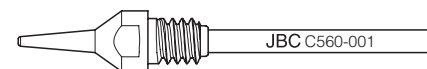

C560-002 ØA=1,8 ØB=0,8 Ømax. pin=0,6

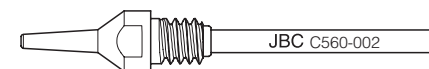

C560-014 ØA=2,5 ØB=0,8 Ømax. pin=0,6

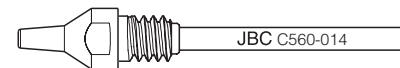

C560-003 ØA=2,7 ØB=1 Ømax. pin=0,8

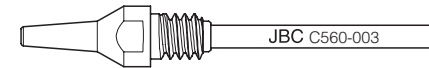

C560-004 ØA=3,2 ØB=1,3 Ømax. pin=1,1

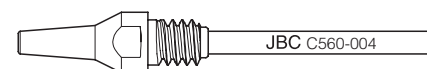

C560-009 ØA=5 ØB=1,3 Ømax. pin=1,1

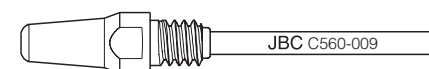

DR560 Changing the Heating Element

To perform this operation, turn off the station or disconnect the tool.

1. Loosening

The deposit lid needs to be loosened.



2. Removing

Loosen the screw as shown and remove the Heating Element.



3. Placing

Place the new Heating Element and follow the steps conversely.

Important

For a proper connection it is essential to insert the cartridge by lining it up to the mark ►|.



DR560 Tin Deposit Cleaning

1. Removing the lid



The lid must be removed with the DR560 in vertical position.

3. Inserting the deposit

The deposit must be inserted with coil filter in place, positioned between the 2 lines marked on the tin deposit.

Then the whole unit must be closed by screwing the lid.

2. Cleaning

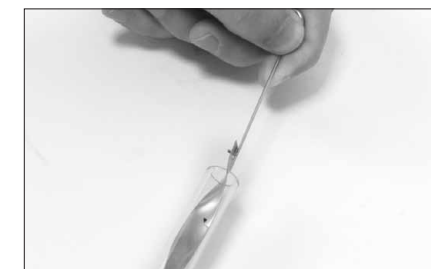

Remove the coil to clean the inside of the deposit with the stick supplied.



The filter and internal joint must be checked and replaced if dirty or damaged.



DR560 Tip Care

The intake tube should be periodically cleaned by the largest rod.



Important

DO NOT press the vacuum pump button while tinning the desoldering tip, as the fumes given off by the flux would quickly block the ducts and the air filter.

Desoldering process

Use a tip with a larger diameter than the pad to achieve maximum aspiration and thermal efficiency.

1. Placing

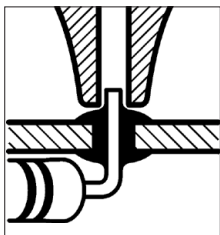

Place the tip with the component terminal in the hole.

2. Rotating

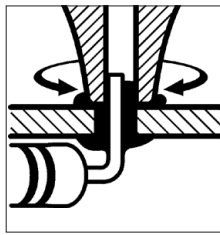

When the solder liquefies, gently rotate the tip so that the component terminal can be lifted off.

3. Aspirating

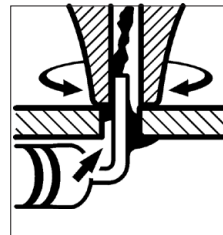

Press the vacuum pump button long enough to remove the solder.

After pressing the desoldering key there is a slight delay until the self-contained vacuum pump stops. This makes sure that the vacuum circuit is completely empty. If any solder remains are left on a terminal after desoldering it, resolder it with fresh solder and repeat the desoldering operation.

MSE Initial Setup

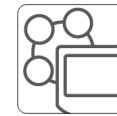

Peripherals

After connecting the electric desoldering module (MSE-A), enter the **Peripherals** Menu and select the port which you want to join with the module.

1. Select the module from the list of peripheral connections. Remember your first peripheral connection is denoted as "a", the second being "b", etc. (e.g. MSE_a, MSE_b,...)

2. Press Menu or Back to save changes. Once set up, you can change the module settings by entering the **Peripherals** Menu.

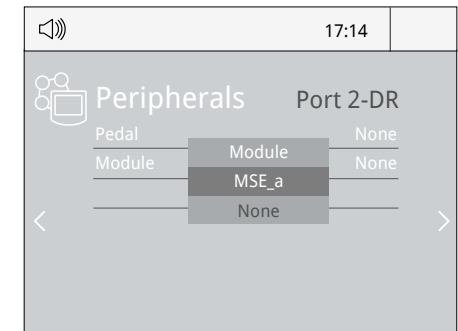

MSE Changing the pump filters

- Clean the casing with a damp cloth. Make sure to use a soft cloth when cleaning the front.
- Periodically check all cable and tube connections.
- Keep filters clean to ensure proper solder suction and replace them when necessary.

Important
Do not use sharp pointed objects to open the suction filter.

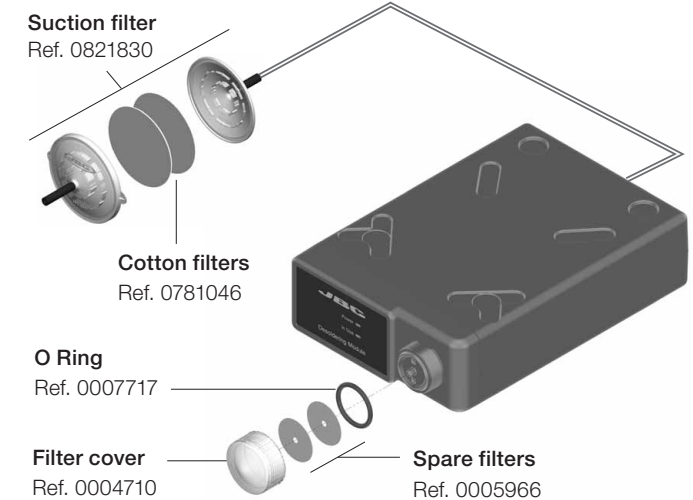

Operation

The JBC Exclusive Heating System

Our revolutionary technology is able to recover tip temperature extremely quickly. It means the user can work at a lower temperature and improve the quality of soldering. The tip temperature is further reduced thanks to the Sleep and Hibernation modes which increase the tip life by 5.

1. Work



When the tool is lifted from the stand the tip will heat up to the selected temperature.

2. Sleep

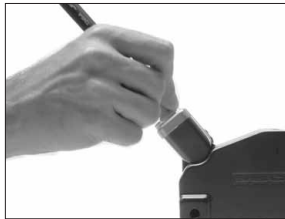

When the tool is in the stand, the temperature falls to 180°C / 360°F (preset sleep temperature).

3. Hibernation



After longer periods of inactivity (pre-set to 30 min.), the power is cut off and the tool cools down to room temperature.

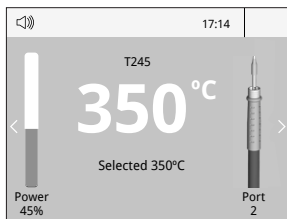

Tools Menu:

- Set temperature limits
- Select temperature levels



Tools Menu:

- Set Sleep temperature
- Set Sleep delay (from 0 to 9 min or no Sleep)

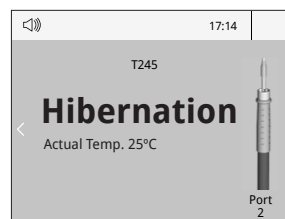

Tools Menu:

- Set Hibernation delay (from 0 to 60 min or no hibernation)

Work Screen

The DDE offers an **intuitive user interface** which provides **quick access** to station parameters.

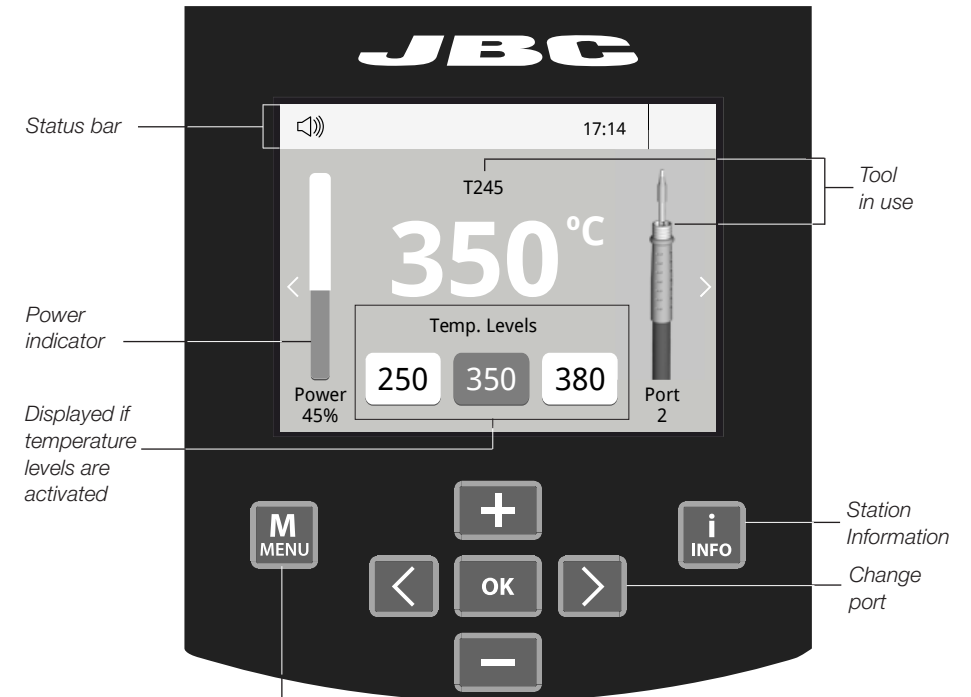

Menu Options

Press INFO for each parameter description.

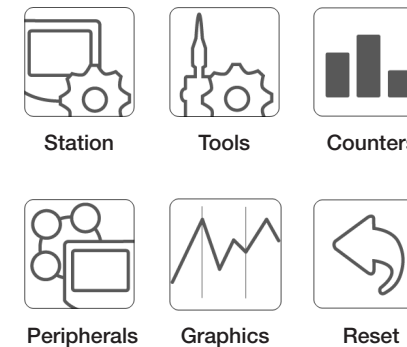

System notifications (Status Bar)

- USB flash drive is connected.
- Station is controlled by a PC.
- Station is controlled by a robot.
- Station software update. Press INFO to start the process.
- Warning. Press INFO for failure description.
- Error. Press INFO for failure description, the type of error and how to proceed.

Process analysis



Graphics

By pressing **Graphics** in the main MENU, temperature and power figures in real time are displayed for each port. This helps you decide which tip to use to obtain the best quality solder joints.



Export graphics

Insert a USB flash drive into the USB-A connector to start saving your soldering process in csv format.



B-Net Soldering Net

Remotely manage and monitor as many stations as your PC can handle.

1. Download the **JBC Manager software** and the user manual from www.jbctools.com/manager.html
2. Connect the stations via USB-B connector and the PC will automatically detect them.
3. The notification  will be displayed on the station.

Functions:

- Set all the station parameters from your PC.
- Organize groups of stations and set all their parameters at the same time.
- Store specific configurations for later uses.
- Analyze the soldering graphics of the stations on your PC and export them.

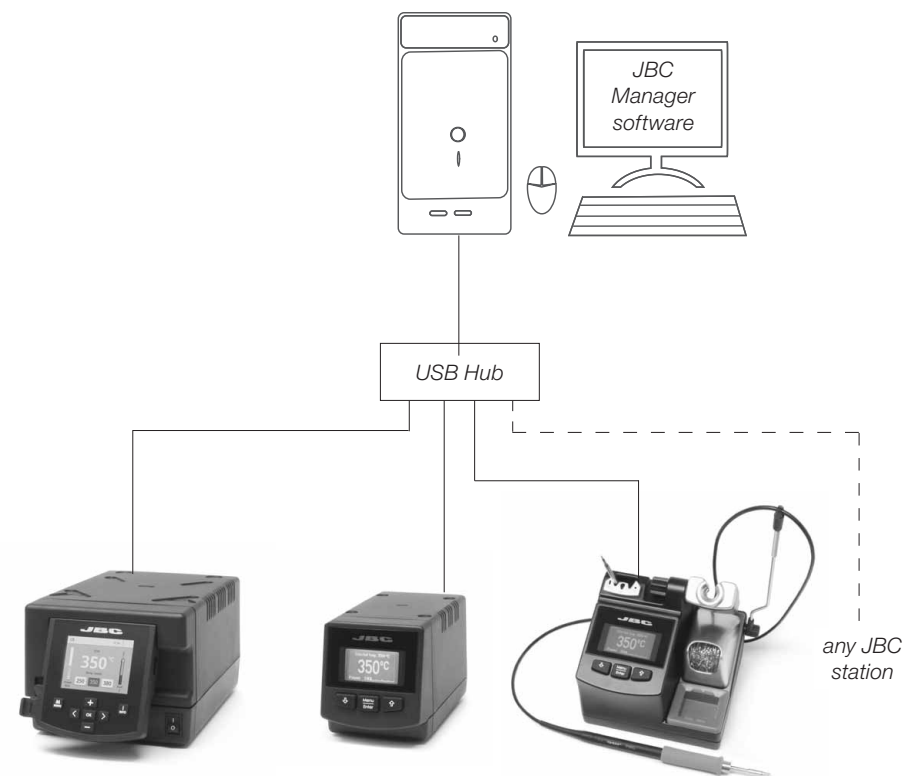

Working with Robots

Manage and monitor the station using a Robotic system.

1. Connect the tool to the station port by means of the Converter.
2. Connect your Robot system to the Robot connector (RJ12) of the station.
DB9-RJ12 Adapter available only if necessary (Ref: 0013772).
3. Enable the Robot option in the station settings and the notification will be displayed: 
4. Set your Robot's commands according to the Robot Communication Protocol, available on the website www.jbctools.com/jbcsoftware-menu-115.html.

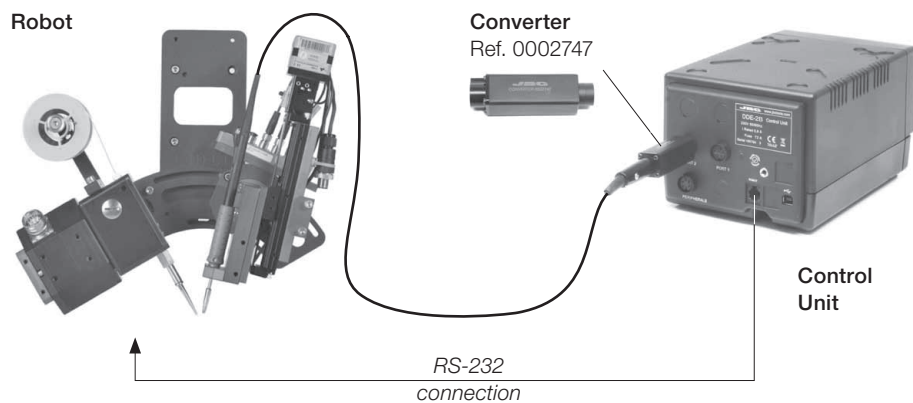

Update the station software

1. Download the JBC Update File from www.jbctools.com/software.html and save it on a USB flash drive. Preferably one with no other files.

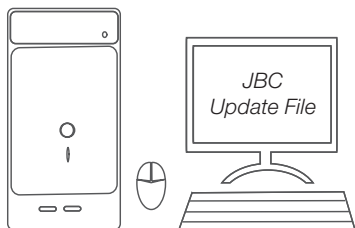

2. Insert the USB flash drive to the station. The icon  is displayed while updating.



Maintenance

Before carrying out maintenance or storage, always allow the equipment to cool.

- Clean the station screen with a glass cleaner or a damp cloth.
- Use a damp cloth to clean the casing and the tool. Alcohol can only be used to clean the metal parts.
- Periodically check that the metal parts of the tool and stand are clean so that the station can detect the tool status.
- Maintain tip surface clean and tinned prior to storage in order to avoid tip oxidation. Rusty and dirty surfaces reduce heat transfer to the solder joint.
- Periodically check all cables and tubes.
- Replace a blown fuse as follows:



Clean periodically

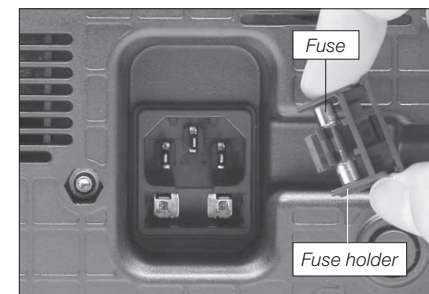
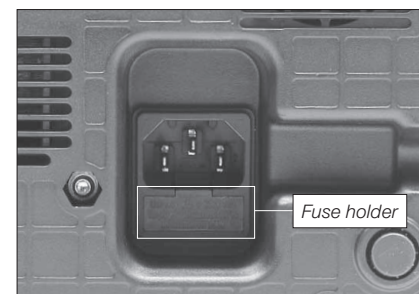
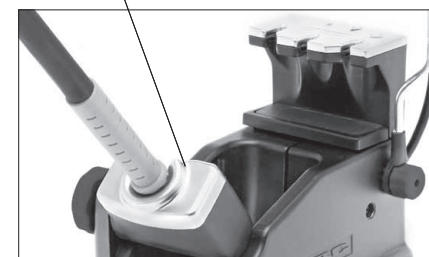

1. Pull off the fuse holder and remove the fuse. If necessary use a tool to lever it off.

2. Press the new fuse into the fuse holder and replace it in the station.

- Replace any defective or damaged pieces. Use original JBC spare parts only.
- Repairs should only be performed by a JBC authorized technical service.

Safety



It is imperative to follow safety guidelines to prevent electric shock, injury, fire or explosion.

- Do not use the units for any purpose other than soldering or rework. Incorrect use may cause fire.
- The power cord must be plugged into approved bases. Be sure that it is properly grounded before use. When unplugging it, hold the plug, not the wire.
- Do not work on electrically live parts.
- The tool should be placed in the stand when not in use in order to activate the sleep mode. The soldering tip, the metal part of the tool and the stand may still be hot even when the station is turned off. Handle with care, including when adjusting the stand position.
- Do not leave the appliance unattended when it is on.
- Do not cover the ventilation grills. Heat can cause inflammable products to ignite.
- Use a "non residue" classified flux and avoid contact with skin or eyes to prevent irritation.
- Be careful with the fumes produced when soldering.
- Keep your workplace clean and tidy. Wear appropriate protective glasses and gloves when working to avoid personal harm.
- Utmost care must be taken with liquid tin waste which can cause burns.
- This appliance can be used by children over the age of eight and also persons with reduced physical, sensory or mental capabilities or lack of experience provided that they have been given adequate supervision or instruction concerning use of the appliance and understand the hazards involved. Children must not play with the appliance.
- Maintenance must not be carried out by children unless supervised.

Specifications

Complete Rework station with Electric Pump RMSE-1C / RMSE-2C / RMSE-9C

- Total weight: 16.6 kg (36.6 lb)
- Ambient Operating Temperature: 10 to 40°C (50-104°F)

JTE-1D 120V 50/60Hz. Input fuse 8A. Rated current: 6A.

JTE-2D 230V 50/60Hz. Input fuse 4A. Rated current: 3A.

JTE-9D 100V 50/60Hz. Input fuse 8A. Rated current: 7A.

- Weight: 3.9 kg (8.5 lb)
- Dimensions: 148 x 184 x 140
- Nominal Power: 700W
- Temperature selection: Room temperature / 150°C to 450°C (300°F to 840°F)
- Cool mode: T Off. Used to blow air at room temperature
- Ambient Operating Temperature: 10 to 40°C (50-104°F)
- Air flow regulation: 10-50 SLPM
- Vacuum: 30% / 228 mmHg / 9 inHg
- USB connector station-PC
- P-005 Pedal Connection

DDE-1B 120V 50/60Hz. Input fuse: 4A. Output: 23.5V

DDE-2B 230V 50/60Hz. Input fuse: 2A. Output: 23.5V

DDE-9B 100V 50/60Hz. Input fuse: 5A. Output: 23.5V

- Weight: 4.3 Kg (9.3 lb)
- Dimensions: 148 x 120 x 232 mm
- Output Peak Power: 150W per tool
- Temperature Range: 90-450°C (190-840 °F)
- Idle Temp. Stability (still air) ±1.5 °C (±3 °F)
- Tip to ground resistance: <2 ohms
- Tip to ground voltage: <2mV RMS
- USB-A / USB-B / Peripherals connectors
- RJ12 connector for Robot

MSE-A

- Weight: 1.2 Kg (2.6 lb)
- Dimensions: 145 x 55 x 225 mm
- Vacuum: 75% / 570 mmHg / 22.4 inHg
- Flow rate: 9 SLPM
- P-005 Pedal connection

Complies with CE standards
ESD protected housing "skin effect"

JBC

Warranty

JBC's 2 year warranty covers this equipment against all manufacturing defects, including the replacement of defective parts and labour. Warranty does not cover product wear due to use or mis-use.

In order for the warranty to be valid, equipment must be returned, postage paid, to the dealer where it was purchased.



This product should not be thrown in the garbage.
In accordance with the European directive 2002/96/EC, electronic equipment at the end of their life must be collected and returned to an authorized recycling facility.